

Choose an Eldeco home.
Live Better.

- 30 Years of expertise
- Present in 12 cities
- 25000 customers
- Over 25 projects under development

175 Projects Delivered



CHANGE
YOUR VIEW
OF

Life

Eldeco Live By The Greens

Features in Phase-I : Club House • Indoor Badminton Court • Swimming Pool • Cabanas • Pool Deck • Party Lawn • Kids' Play Areas • Luxurious AC Entrance Lobbies • Cafe' • Seating Area

Features in Future Phase: Cricket Field • Cricket Academy • Lawn Tennis • Half Basketball Court • Climbing Wall • Chess Paving Feature • Tot-lot Area • Skating Rink • Amphitheater • Multi-purpose Lawn • Kids' Play Areas

The Eldeco Live by the Greens (Phase II, having RERA registration number UPRERAPRJ15172 and its details are available on website- <http://up-rera.in>. The project is being developed by Wondrous Buildmart Private Limited (Wondrous) having CIN U70102UP2016PTCO77236, having registered office at 7th Floor, Tower B, Plot no. 8, sector 127, Noida, Uttar Pradesh - 201301, Tel No- 011-40655000. Wondrous is a joint venture between Lotus Greens Constructions Pvt. Ltd. and Eldeco Infrastructure & Properties Ltd.

Disclaimer: This is not an offer or an invitation to offer and/or commitment of any nature. Recipients are advised to apprise himself/ herself/themselves of the necessary and relevant information prior to making any purchase decisions. All specifications of the unit shall be as per the final agreement between the parties. The inclusions reflected in the image are not part of the offer and are only illustrative in nature.

ELDECO

Call: 9650775959

Site Office: SC-02/A9, Sec -150, Noida
Email: contact@livebythegreens.com
Website: www.livebythegreens.com



All perspective shots and amenities shown in the brochure are artistic impressions. The perspective and colours are definitely not to be referred to at the time of completion.

What if you could live surrounded by the greens? Wake up every morning to be greeted by the freshest of the hues, and end your day witnessing the sun go down over the open greens? What if the myriad shades of green unfolded opportunities to savour life in a way like never before, as you live, grow, play and socialise?

Well, now you can. It's time to embrace a new life; and change to your new home – Eldeco Live By The Greens.



ELDECO
Live by the
Greens

PHASE-1
SECTOR 150, NOIDA
2/3 BR APARTMENTS



CHANGE TO HOMES WITH OPEN GREENS ALL AROUND



We have created a world spread around a cricket field where life offers numerous ways to relax and rejuvenate after a hard day at work. It's a life inside a healthy environment that reinvigorates your mind and body.

- Relish the large open greens
- Stay energised in the healthy living environment
- Breathe fresh all day
- Walk & jog amidst greens





CHANGE TO HOMES WITH A RESORT-LIKE LIFESTYLE

Live the way you would in a resort. It has all been designed to give you a relaxed outlook.

- Chill out on the poolside cabanas as you chat, read a book or simply work on your laptop
- Swim a lap or two in the swimming pool and bask on the loungers
- Grab a bite at the café
- Experience a sense of arrival at the well-appointed entrance lobby



CHANGE TO HOMES WITH WORLD-CLASS SPORTS FACILITIES

Be a sport for life with the sports facilities here. Whatever be your preference, you have a choice.

- Do a lot in the sprawling cricket field right in the middle of the complex; show off your cricketing skills in a friendly match or play the spectator and cheer from the grass sloped seating and pavilion
- Enjoy a quick round of badminton in the comforts of the indoor court
- Sweat it out with a leisurely game of lawn tennis
- Casually dribble and throw a hoop at the half basketball court





CHANGE TO HOMES WITH AN ACTIVE SOCIAL LIFE

Love to mingle? This is the place for you. Whether it's about old friends coming over or making new ones in the neighbourhood, your social life is sure to thrive here.

- Meet and greet in style at the café
- Stage a play with your kids' theater group at the amphitheater
- Chat with neighbours at sundown under a cabana
- Celebrate your family occasions in the party hall



CHANGE TO HOMES WHERE THE KIDS HAVE FUN TOO

Anytime is fun-time here for the little ones. All their needs for excitement and activities have been well taken care of.

- Let them play all they want in the kids' play areas within the kids-friendly complex
- Cheer for them as they go up the rock climbing wall*
- Watch over your toddler from a guardians' seat as he plays in one of the multiple tot-hot areas
- Check out the youngsters as they go for a spin at the skating rink*



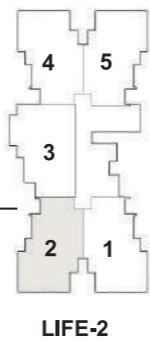
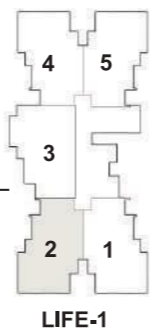
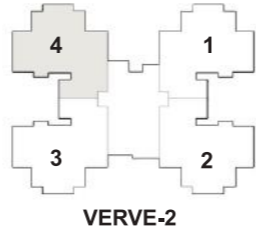
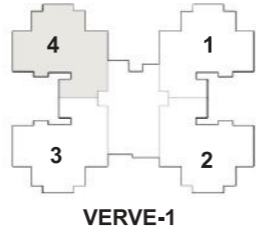
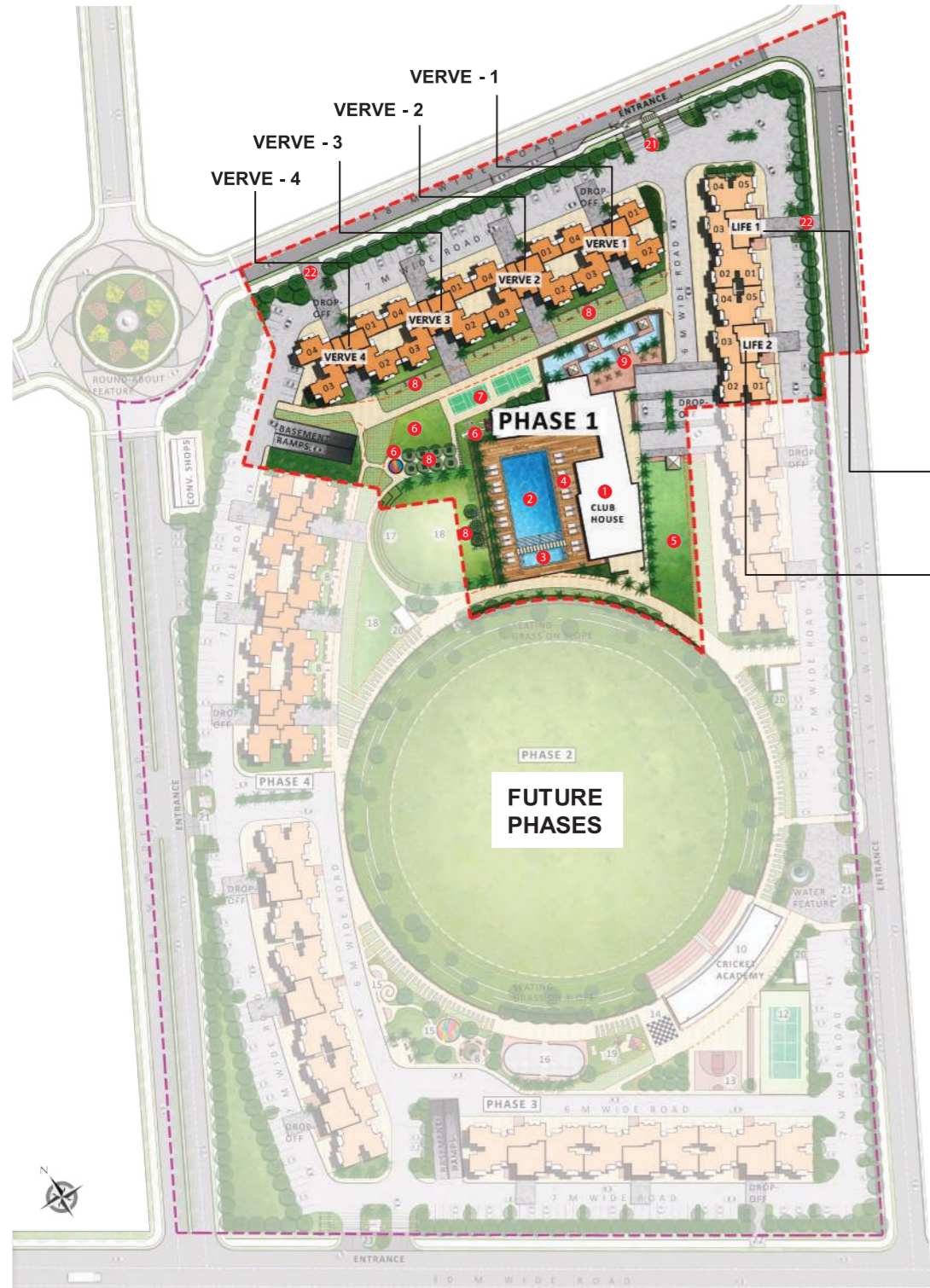

AMENITIES

Phase 1

- 1 Club House
- 2 Swimming Pool
- 3 Kids' Pool
- 4 Pool Deck
- 5 Party Lawn
- 6 Kids' Play Area, Tot-lot
- 7 Badminton Courts x2
- 8 Seating Areas
- 9 Water-side Cabanas
- 21 Entrance Structure with Guard Room
- 22 Pedestrian Entrance

TOWER TYPES

- LIFE** (2 BHK)
- VERVE** (3 BHK)

**OPEN UP TO A
GREAT LOCATION**



Eldeco Live By The Greens, located in Sports City at Sector-150, Noida is an expansive area designed to be a dream destination for the young generation. The city features numerous recreational sporting facilities enabling a healthy, active and purposeful life.

- It is the greenest sector of Noida with about 80 percent of green cover.
- Shaheed Bhagat Singh Park, spread over 40 acres, the biggest in the country is at a walking distance.
- The low-density of this sector means more open spaces per family.
- Easily accessible location through 6-lane Noida-Greater Noida Expressway.
- Location is near the upcoming FNG (Faridabad-Noida-Ghaziabad) Expressway.
- Easy connectivity to rest of NCR via the Noida-Greater Noida Metro.
- Best of schools like DPS, Amity, Apeejay, Lotus Valley, Pathway, Shriram Millennium, Step-by-Step are within 15 min drive.
- There are many hospitals in close vicinity like Jaypee, Yatharth and Fortis.
- The best of social infrastructure is nearby, like Sector-18 Market, DLF Mall of India, Great India Place, Great Venice Mall, World of Wonder, Water World, Lotus Greens Broadwalk (under development), Expocentre and more.
- The upcoming Jewar Airport, located at 20 min drive, will be operational in the next 5 years*. Approaching from the new airport, Sector-150 would be amongst the first sectors in Noida.

Location Map

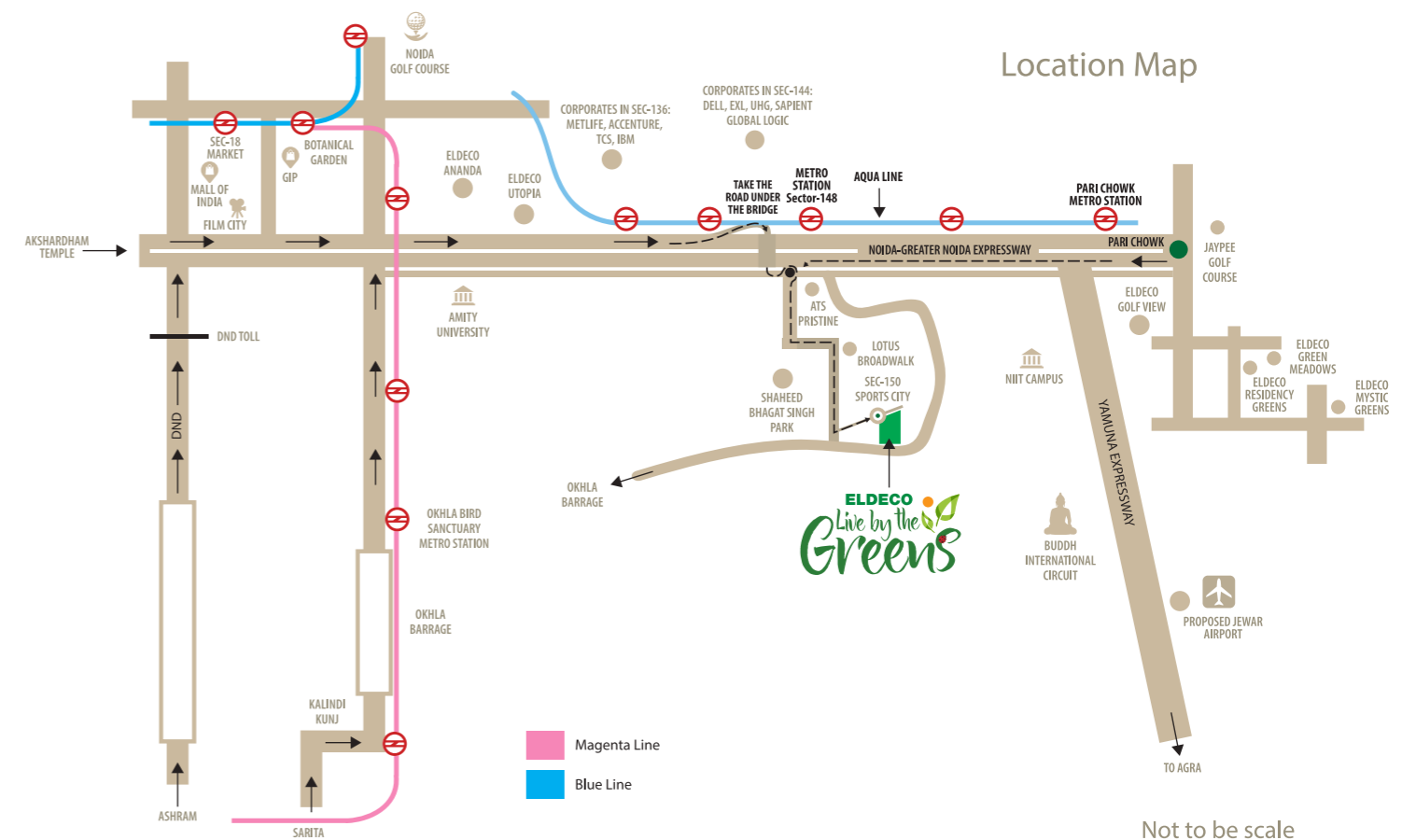

Not to be scale

Disclaimer

- Only Phase-1 is final
- The above plan is indicative. Future phases are conceptual and subject to change. Please check actual plan with marketing
- Please go through the detailed terms of allotment before making a booking
- The entire project will be developed in phase wise manner
- The terms of Agreement to Sublease/allotment shall supersede everything.

*As per media reports